

# Si-20 (120 V ~ 60 Hz) Split & Multisplit System

N021-00 Edition 25/31

# Si-20 (120 V ~ 60 Hz) VRF System

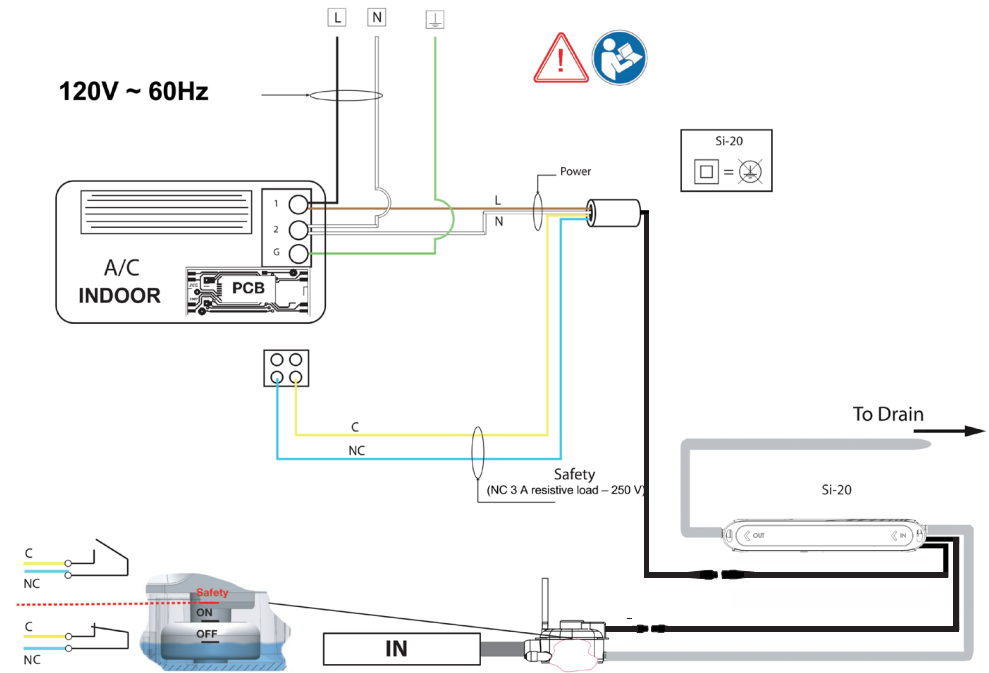

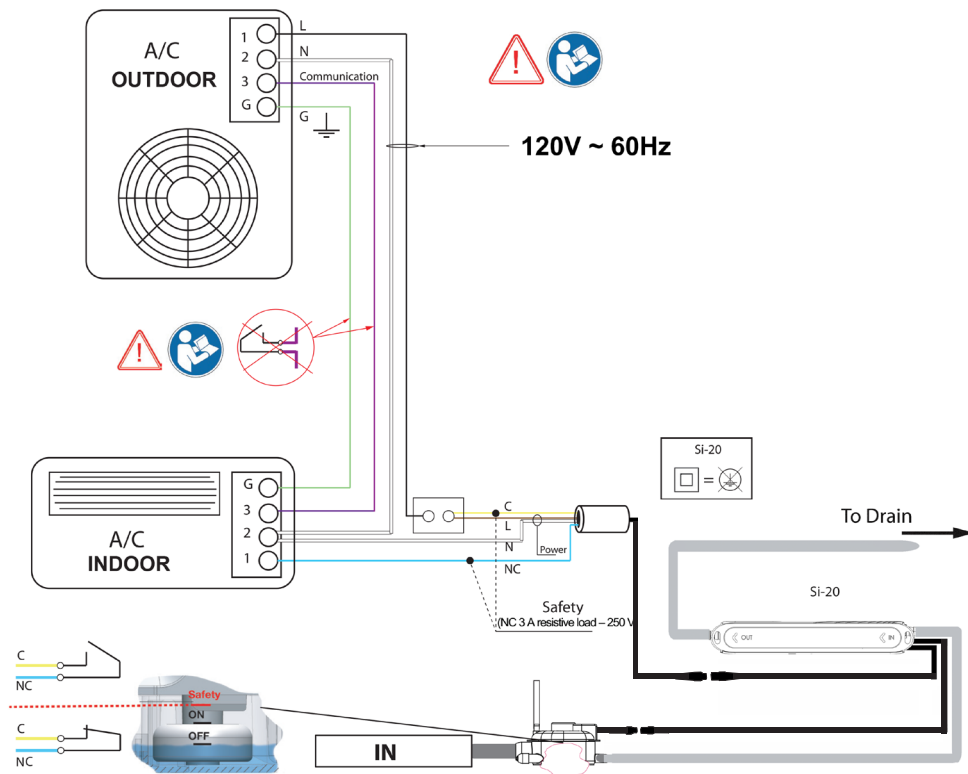

# Si-20 (208 - 230 V ~ 50/60 Hz) Split & Multisplit System

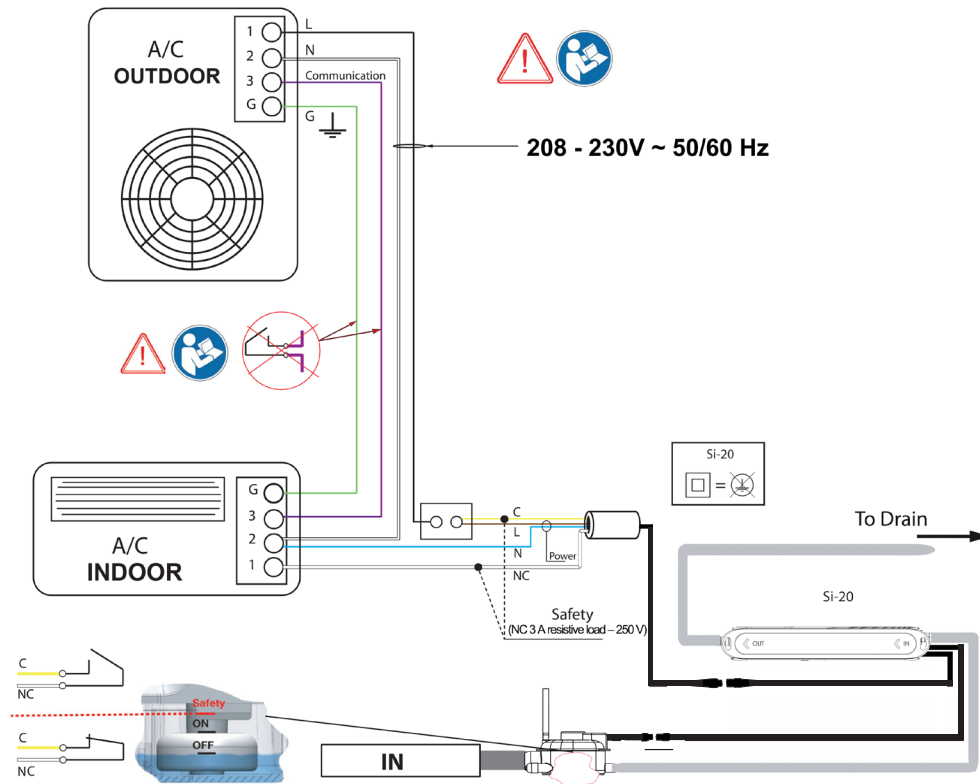

# Si-20 (208 - 230 V ~ 50/60 Hz) VRF System

